

GECKO

Start



**DEVIALET**

INGÉNIERIE ACOUSTIQUE DE FRANCE

Gecko was invented by Devialet, Ingénierie Acoustique de France, the world's most awarded start-up for the excellency of its innovations in sound technologies

Made in France

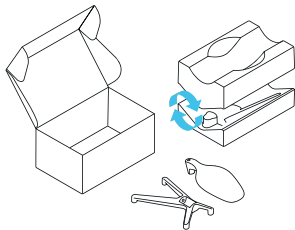

# 1

Carefully remove all the pieces from the box. Take out the polystyrene blocks, turn and fit them together.



# 2

To protect your PHANTOM, handle it with care and do not touch the loudspeakers.

# 3

Carefully turn your PHANTOM over and place it in the pit of the protective foam.

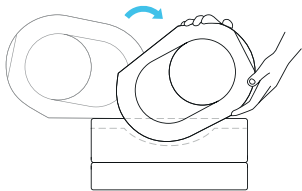

# 4

Attach the plate to the back of PHANTOM, push forward to compress the spring, press it down, then slide it back to lock it into place.

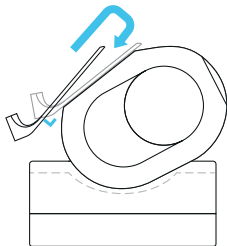

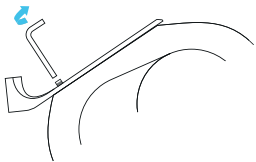

# 5

Fasten the plate and the PHANTOM together with the screw and hex key provided.

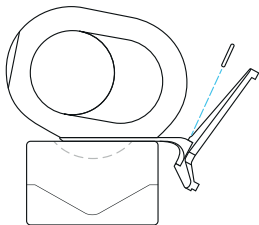

# 6

Turn Phantom right-side up on the foam with the plate as the base. Attach the wall mounting to the base with the metal rod provided. A click should be heard if well mounted.

# 7

Use the template provided to accurately install the wall mount. Drill the anchor mounts into the wall using the appropriate screws for your surface.

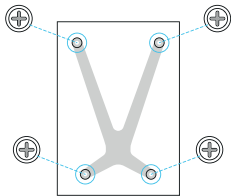

# 8

Pass the cables through the cover. Connect your cable to the back box.

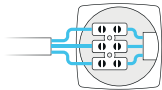

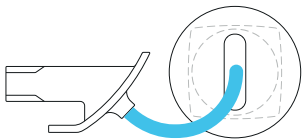

9  
Remove the adhesive film on the back of the cover then stick the cover to the front of your junction box.

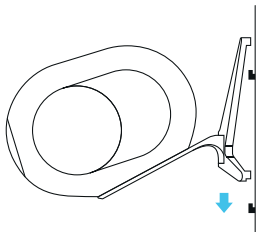

10  
Attach Phantom and its bracket to the wall by sliding the legs simultaneously onto the 4 hooks.

# 11

Connect the power cable to your PHANTOM.

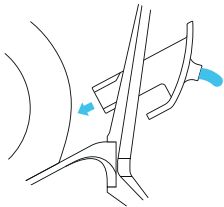

# 12

Adjust the angle and secure PHANTOM in position with the hex key.

